

Fundraising Priorities for the Kopchick College of Natural Sciences and Mathematics

At the Kopchick College of Natural Sciences and Mathematics, we believe that when students engage in research, they don't just learn science—they become scientists. Our students are driven by curiosity, and your support allows them to transform ideas into action. Whether they're studying environmental change, advancing health sciences, or exploring the universe through our planetarium, your generosity gives them the confidence, skills, and experiences that will define their futures.



Supporting Student Research: Empowering Tomorrow's Leaders

Your Impact: Your generosity builds a nurturing and inspiring environment where students can excel academically, innovate boldly, and achieve remarkable personal and professional growth. Your support makes it possible for our students to dream big, succeed passionately, and make meaningful contributions to the world around them.

Student Research Grants

Goal: \$250,000 endowment

Your gift to Student Research Grants fuels student discovery. These grants provide critical funding for undergraduate research projects, allowing students to explore their scientific passions, test ideas, and gain invaluable hands-on experience. These experiences build confidence, sharpen problem-solving skills, and prepare students to contribute meaningfully to their fields as future scientists and innovators. You're not just funding research; you're helping students launch their careers and ignite a lifelong passion for discovery.

College Research Van Fleet

Goal: \$75,000 each

Field-based research is critical to preparing our students for real-world challenges. Research vans are essential for collecting environmental data, visiting geological sites, and enabling low-cost travel to career fairs and conferences. Your contribution ensures our students gain practical experience while expanding their networks and horizons.

Snively Endowment for Student Professional Development

Goal: \$500,000 (\$250,000 pledged)

The Snively Endowment for Student Professional Development provides financial support for our students to engage and interact with the broader scientific community through participation in professional conferences and travel to internship research sites. Opportunities like these enable our students to share and communicate the importance of their research and build connections with other scientists and ultimately building a stronger scientific community for all.

Kopchick Science on Display

Goal: \$40,000

Imagine students' pride as their research is showcased in vibrant displays across campus. These exhibits bring science out of the lab and into daily life, sparking curiosity in every student, visitor, and community member. With your support, we can create dynamic, interactive displays that make science accessible, exciting, and relevant for all.

Do you prefer to make an impact through scholarships?

To endow a scholarship, a minimum contribution of \$25,000 is required, while a minimum of \$5,000 is needed for current-use scholarships. Contributions can be pledged and paid over a five-year period.

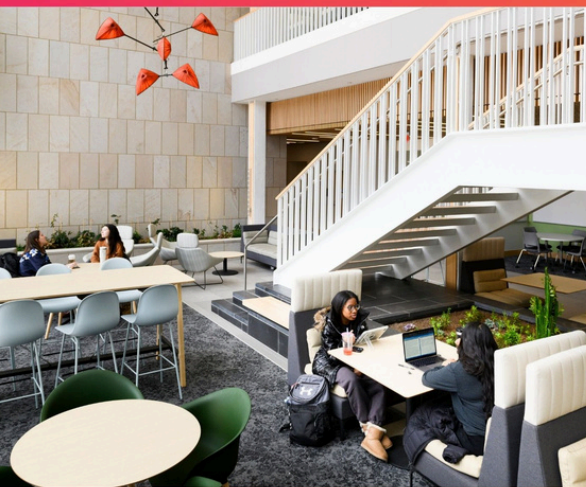

Supporting Faculty Research: Advancing Knowledge, Mentoring Scholars

Your Impact: Our faculty are pioneering researchers and dedicated mentors. Their work shapes not only their fields, but also the student experience—providing opportunities for students to work alongside them on cutting-edge projects. Your investment helps attract and retain world-class faculty who inspire students and advance science that benefits society.

Endowed Faculty Fellowship Program

Goal: \$2 million endowment (\$200,000 pledged)

Your investment in Endowed Faculty Fellows ignites the spark of discovery and fuels groundbreaking research that shapes the future of science and education. This prestigious fellowship provides stable, long-term funding that allows our faculty to pursue bold, high-impact research without the constant uncertainty of external grant cycles.

But the impact of your generosity reaches far beyond the lab. Faculty research fellows directly mentor and engage students at every stage of their projects—from formulating research questions to analyzing results and sharing findings with the world. This unique, immersive learning experience prepares students for graduate study, competitive fellowships, and leadership in STEM fields.

When you support an Endowed Faculty Research Fellow, you are helping to build a legacy of excellence that will inspire generations of students, drive discovery, and elevate the reputation of the Kopchick College as a leader in STEM education and research.

Research Equipment Support

Goal: \$100,000 annually or \$3 million endowed

Access to modern equipment transforms learning, giving students invaluable experience with the tools they'll use as professionals. Your generosity provides everything from advanced microscopes to field sensors—resources that make exploration and discovery possible at every level.

Dean's Innovation Fund

Goal: \$100,000 annually or \$3 million endowed

The Dean's Innovation Fund is your opportunity to directly impact the lives and futures of our students at the Kopchick College of Natural Sciences and Mathematics.

By supporting this vital fund, you empower our students and faculty to seize exciting new opportunities, explore groundbreaking ideas, and pursue creative, interdisciplinary projects that enrich their educational journey. Your generosity provides the essential flexibility to swiftly invest in innovative initiatives, pilot cutting-edge educational experiences, and ignite the spark of discovery in every student to place our college at the very forefront of scientific innovation and academic excellence.